



**KEEPING SMALL
MAINTENANCE PROBLEMS
SMALL.**



RIDGELINE
FLUIDS ANALYSIS



AVOID EQUIPMENT FAILURES. REDUCE DOWNTIME. SAVE MONEY.

Oil analysis has been proven internationally as an effective method of reducing maintenance costs, improving productivity and providing peace of mind in industries which operate large fleets of plant equipment, aircraft or heavy-duty vehicles.

The Ridgeline Fluids Analysis Program works with ISO 17025:2017 accredited laboratory, WearCheck, to provide a health check for your lubricants and machinery. It is an oil condition monitoring service that aims to keep your business running smoothly by helping to identify potential oil or equipment failures before they become critical.



APPLICATIONS

Engines / Powertrain	Detects subtle changes in the levels of wear metals present in the system oil
Gearbox / Hydraulics	Detects the ingress of contaminants from the manufacturing environment, including process contaminants, dirt, and water in order to alert you in time to perform filtration service, to save the oil and avoid unnecessary wear
Steam, EHC, Hydroelectric	A comprehensive diagnosis will warn you of any potential for damaging varnish build-up and includes recommendations for any necessary maintenance actions to remove contaminants and restore the lubricant to proper operating conditions
Oil Cooling System	Provides an assessment of the condition of the cooling fluid and is used to determine optimum service intervals
Electrical Transformer	Provides a diagnostic state of the transformer and insulation system through a series of tests of the dielectric oil
Bearings, Hubs	Detection of ingress contaminants from the manufacturing environment, including process contaminants, dirt, and water alerts you in time to perform a grease service, avoiding unnecessary wear
Gearbox, Bearings	Unmonitored, poor oil condition will lead to varnish and shellacking resulting in gearbox failure

HOW IT WORKS

It's easy as...

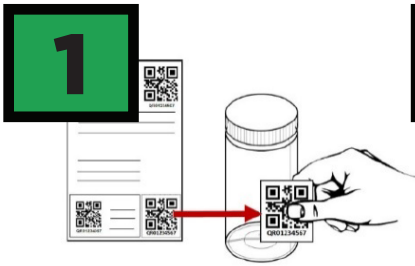

Place QR tag on bottle



Take equipment oil sample



Scan and complete equipment info

Submit and Send.

DATA AT YOUR FINGERTIPS

RECEIVE A CLEAR DIAGNOSIS AND ANALYZE YOUR RESULTS.

Your report, which can be accessed via the WearCheck Mobile App or via PC (WebCheck Online), will provide our diagnosis and recommendations using a straightforward traffic light system.

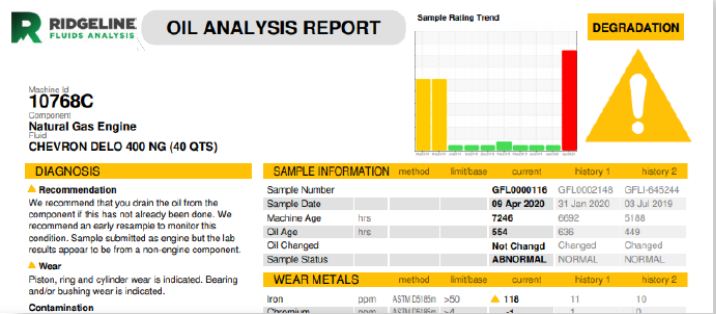

OUR PACKAGE SOLUTIONS



BASE PACKAGE

Test	Method
ICP Spectroscopy	ASTM D5185m
Visual Screen	WearCheck Method
Water / Crackle Test	Crackle Test
Kinematic Viscosity @ 40C	ASTM D7279/D445
Kinematic Viscosity @ 100C	ASTM D7279/D445
% Water/Karl Fischer/Volumetric	ASTM D1744
% Water/Karl Fischer/Coulometric	ASTM D6304
Soot/Oxidation / Nitration / Sulphation FTIR	ASTM E2412 Mod
% Fuel	ASTM D3524 Mod
Glycol	ICP/FTIR/KF Screen
Base Number FTIR	ASTM E2412 Mod



SUMMIT PACKAGE

Test	Method
ICP Spectroscopy	ASTM D5185m
Visual Screen	WearCheck Method
Water / Crackle Test	Crackle Test
Kinematic Viscosity @ 40C	ASTM D7279/D445
Kinematic Viscosity @ 100C	ASTM D7279/D445
% Water/Karl Fischer/Coulometric	ASTM D6304
% Water/Karl Fischer/Volumetric	ASTM D1744
Soot/Oxidation / Nitration / Sulphation FTIR	ASTM E2412 Mod
% Fuel	ASTM D3524 Mod
Glycol	ICP/FTIR/KF Screen
Acid Number ASTM	ASTM D974/D8045
Ferrous Debris (PQ)	ASTM D8184 Mod
ISO Particle Count	ASTM D7647
Base Number FTIR	ASTM E2412 Mod

The **Ridgeline Fluids Analysis Program** is a full fluids service program. In addition to oil, the program includes analyses for coolants, fuels, greases, filters, thermal fluids and transformer fluids.